

VICINITY MAP

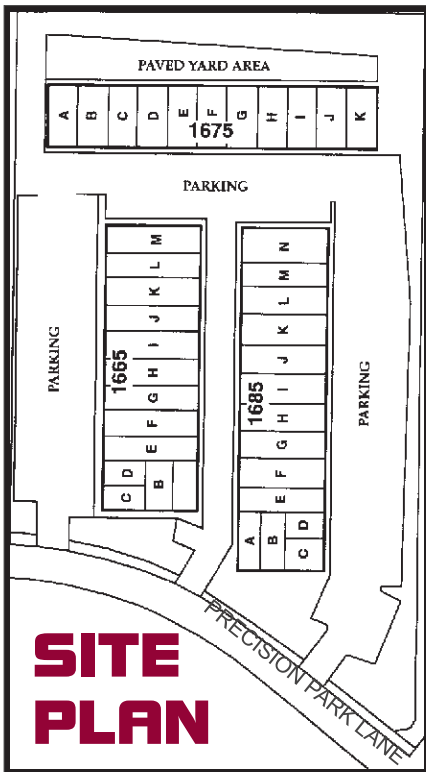

STREET MAP



Freeway International Business Park

1665-1685 Precision Park Lane • San Ysidro, CA 92173



LOCATION

Located near the Intersection of three primary freeways, I-5, I-805 & Hwy 905, with easy access from all directions. The site is just 20 min. from downtown San Diego and 5 min. To the Mexico border and walking distance to the Trolley.

SITE SPECIFICATIONS

3.5 acre site with 53,454 sq ft of office/industrial space in 3 separate buildings. Abundant parking - 2 1/2 per 1000 sq ft.

NOW LEASING

Call for immediate availability on office/warehouse units from 1400sf - 4,000sf

Smiser Family Properties

Tel/Fax 619/342-7207 x6 • Email lc@smiser.net

Freeway International Business Park

1665-1685 Precision Park Lane • San Ysidro, CA 92173

SITEPLAN

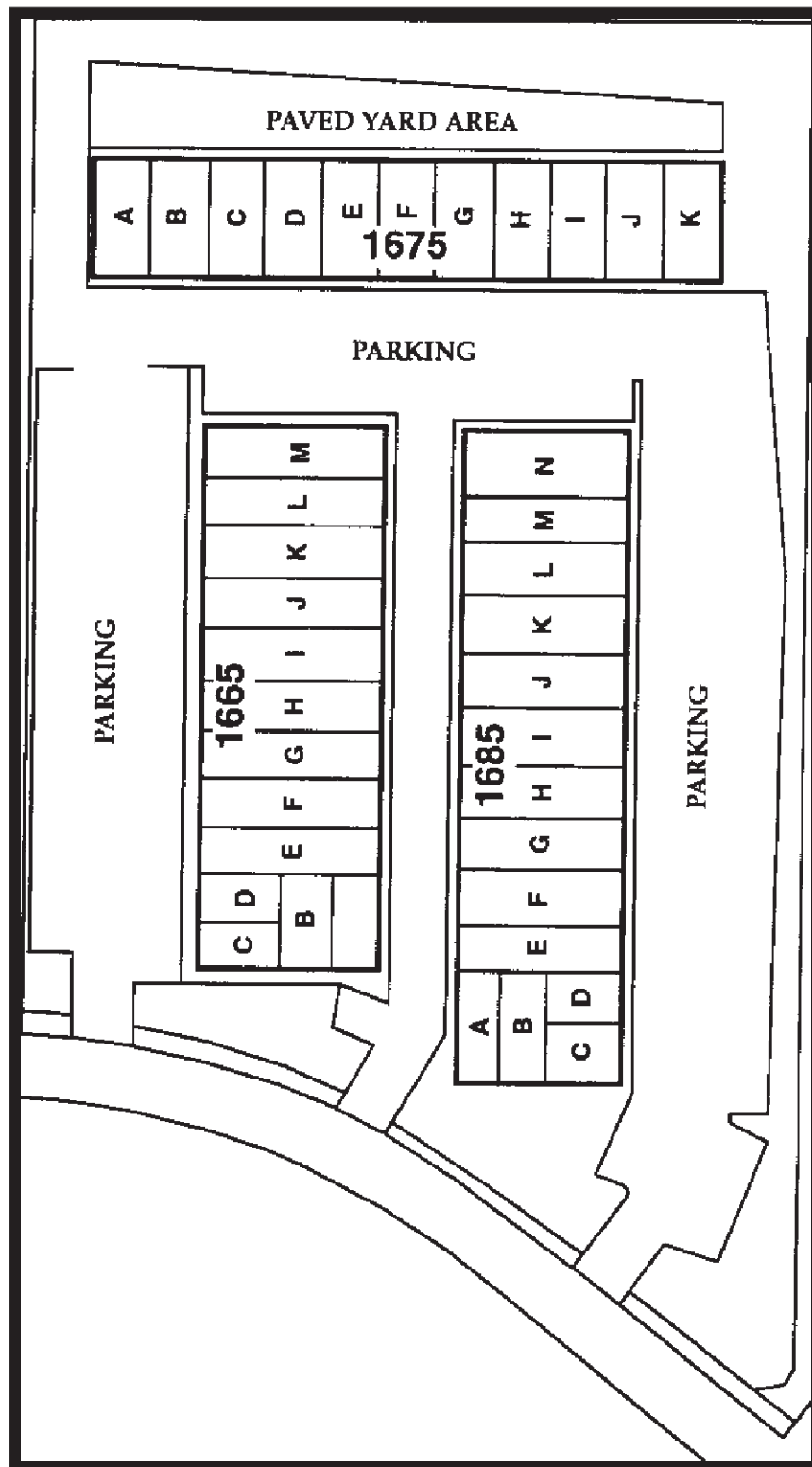

Freeway International Business Park

1665-1685 Precision Park Lane • San Ysidro, CA 92173

AERIAL VIEWS

